

I. Installation Notice

1. Install water supply lines in accordance with this manual.
2. Floor drain should be installed in the location of the faucet.
3. Install the faucet only after the completion of house interior decoration in case paint or other chemicals erode the faucet surface.
4. Clean pipes to get rid of mud, sand or other debris blocked in pipes.
5. Wrap the thread part with Teflon tape before it is screwed. To avoid damage to the faucet, use a piece of cloth as a pad between the wrench mouth and the faucet. (Check whether the threads can be matched. Otherwise, too strong force applied to the wrench will damage the faucet).
6. After installation, check all the joints to make sure they are firmly connected. Then keep water flow. Turn on and off repeatedly to ensure there is no leakage around the joints. At this stage, the product is ready for normal use.
7. Keep the manual to the user.

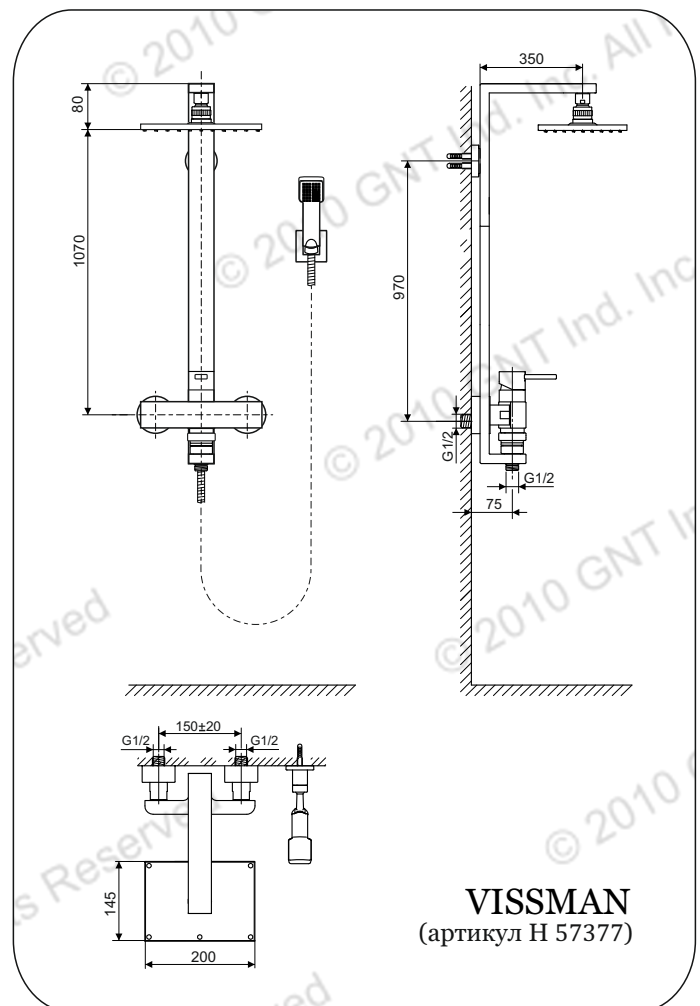

II. Operation Notice

1. The product is used between water pressure 0.05~1.0 MPa, water temperature 0~90 C.
2. Do not hang heavy things on the faucet.
3. Make sure the faucet is off when no water comes out of it (especially when nobody resides in the house or during the period of decoration or the absence of water).
4. Regularly clean the surface of the faucet in neutral wash solution. Then dry it with a piece of soft cotton cloth to keep it bright.
5. When the room temperature drops to 0 C, take necessary measures (such measures as keeping faucet warm and closing windows) to prevent the faucet from being frozen or even broken (especially when windows kept open for air ventilation while nobody resides in).

6. First turn on cold water. To avoid scalding, regulate the water temperature before washing or showering and do not touch the faucet of the hot water part.
7. Do not disassemble the product unless you are an expert.



It's your Style...

- 1** Place the two S-connectors to connect with water pipe head

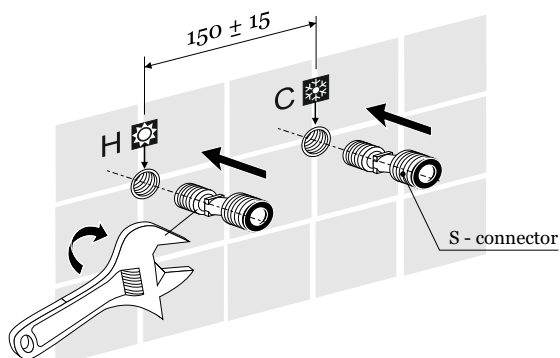

- 2** Adjust the S-connectors parallel and even with each other. The center distance is 150 mm

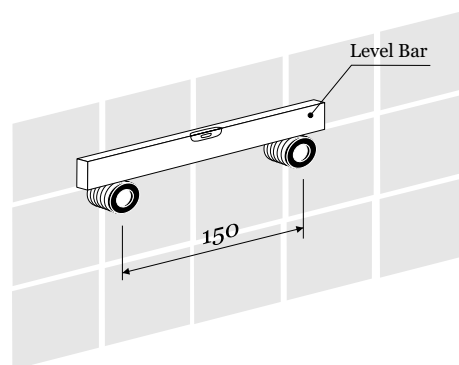

- 3** Install the escutcheons on the pipe joints of faucet body. Then connect the water supply connectors and connecting nuts and tighten and tighten them.

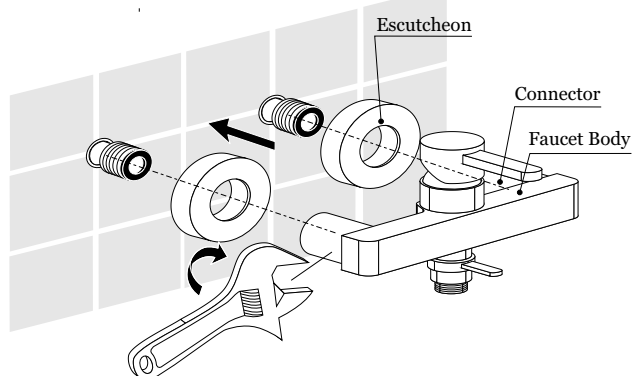

- 4** Connect the rainshower and elbow and tighten them with locking screws.

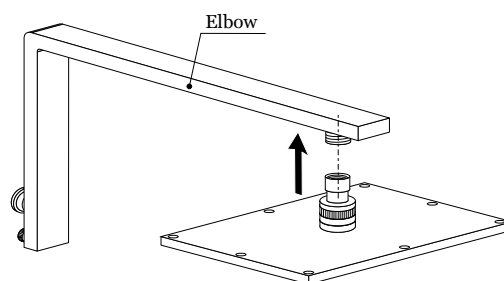

- 5** Push the base onto the connecting links and fix with M6 screw. The middle connection tube with «up» mark at one end should be inserted into the elbow.

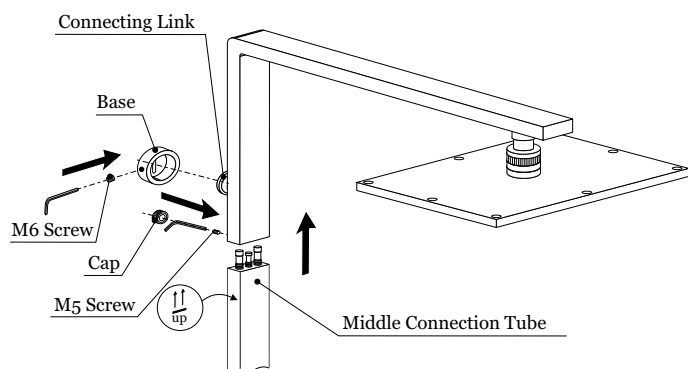

- 6** Insert the middle connection tube into the faucet body and adjust it in a vertical position. Then draw lines based on the base

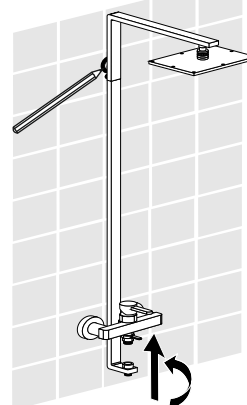

- 7** Remove the middle connection tube

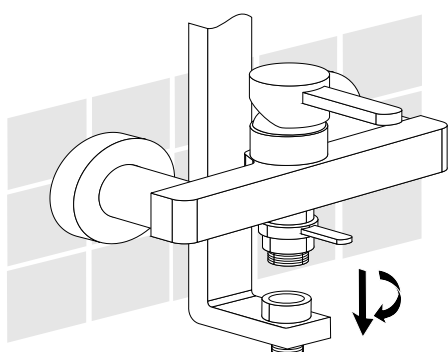

- 8** Remove the base from the elbow

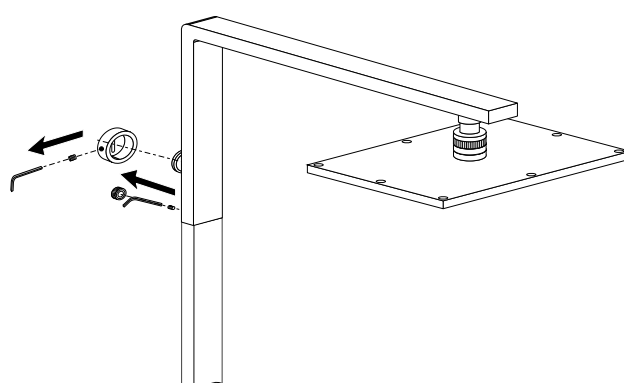

- 9** Based on the kidney slot of base to draw lines in a circle for positioning

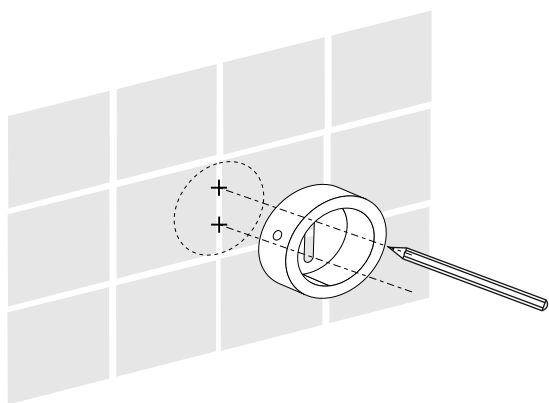

- 10** Drill 3 8 holes at the marked position (attention: cover the faucet body with packet or plastic bag to avoid sand or mud falling into it)

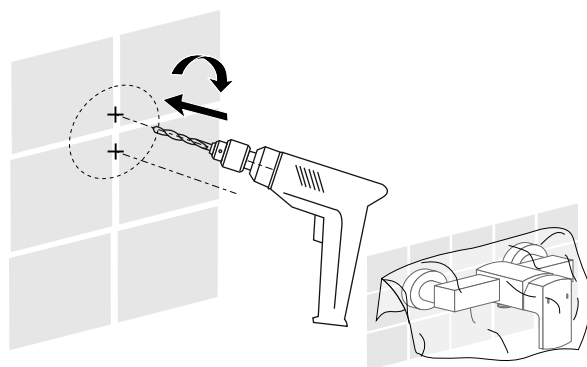

- 11** Insert the expansion pipes and fix the base on the wall with self-tapping screws

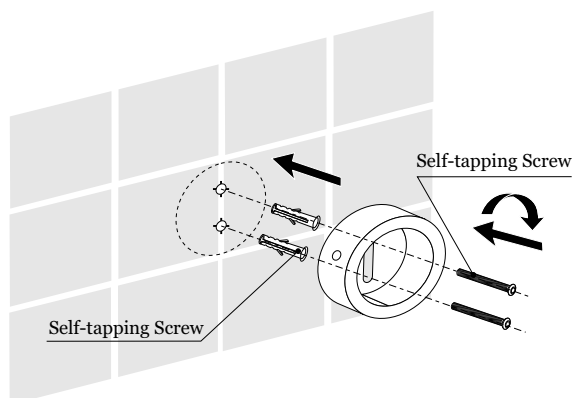

- 12** Insert the middle connection tube into the faucet body (attention: there is no gap between faucet body and tube). Insert the connecting links into the holes of mounting plate and tighten the M5 screw on the faucet body. Then tighten the M6 screw and set screw on the mounting plate

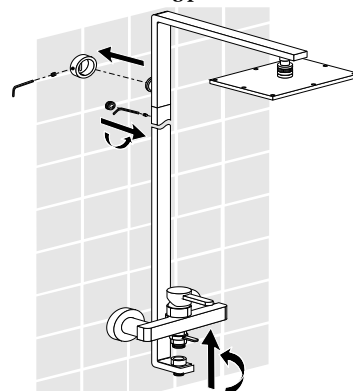

- 13** Unscrew the M5 screw and remove the mounting plate

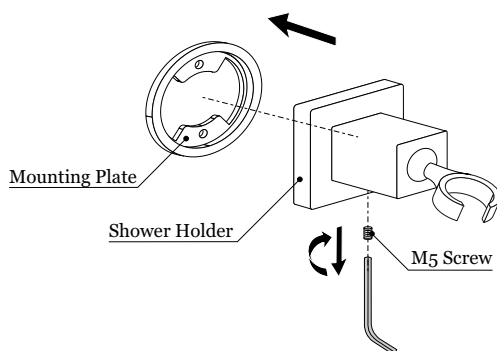

- 14** Based on the kidney slot of mounting plate to draw lines in a circle for positioning

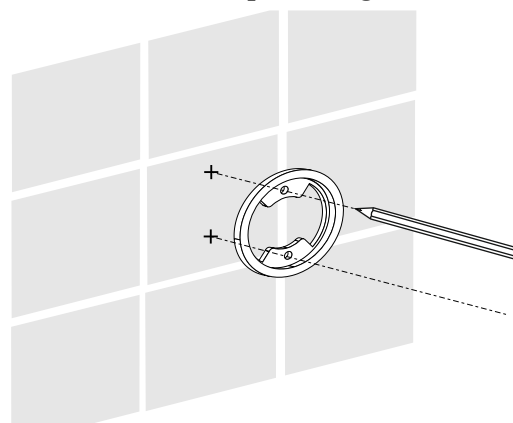

- 15** Drill 2 8 holes at the marked position

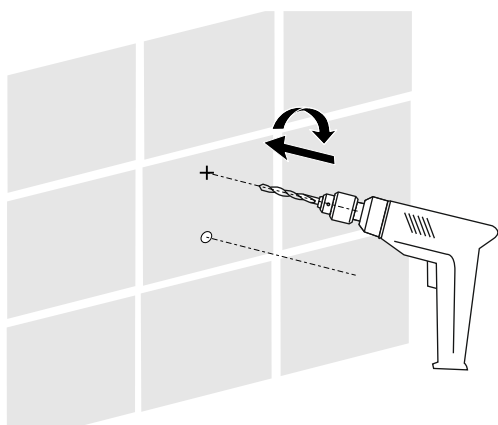

- 16** Insert the expansion pipes and fix the mounting plate on the wall with self-tapping screws. Then install the shower holder and tighten it with M5 screw

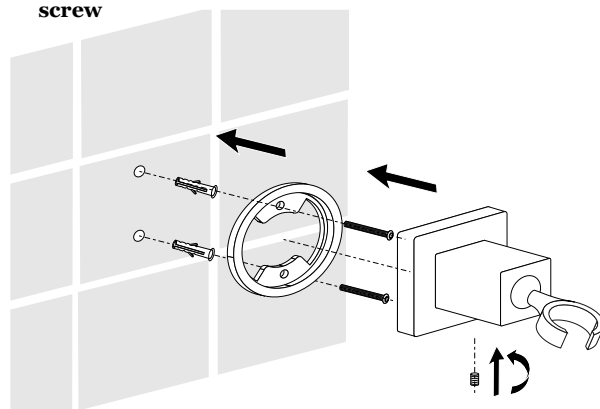

17

Take off the sheath from the faucet body and connect the handshower and faucet body with flexible hose

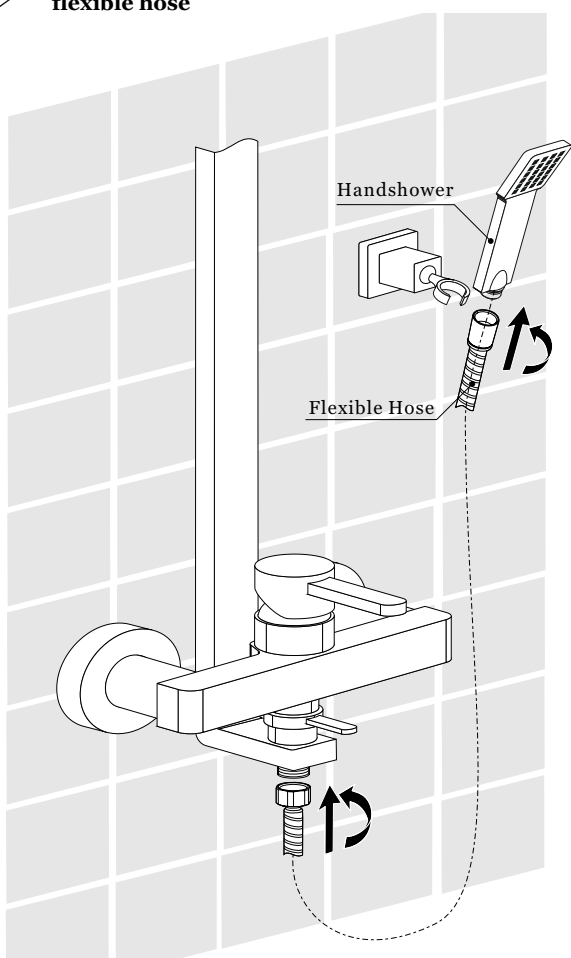

18

After installation, run water for inspection. The figure is for the case when handle is turned on and rainshower is in the state to rain outlet

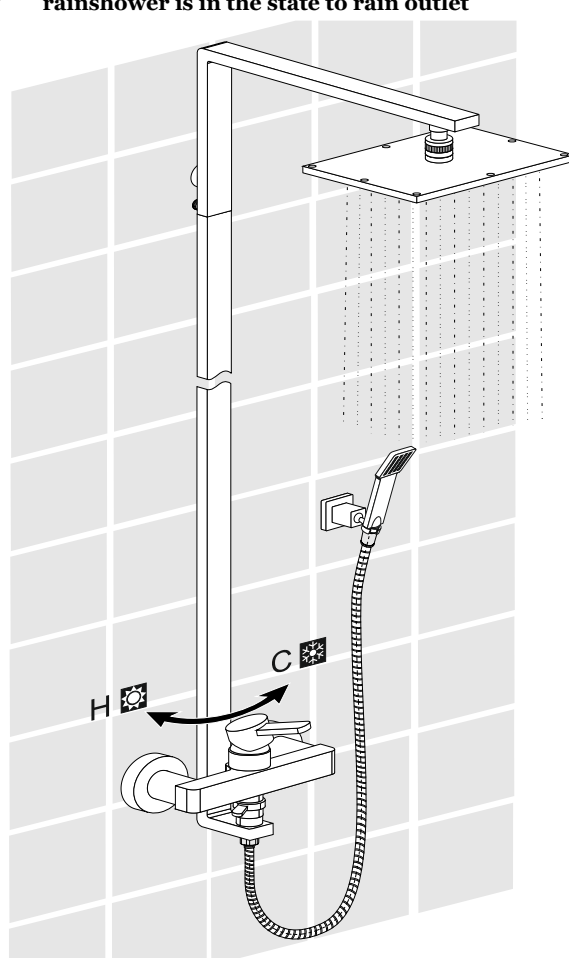

19

Switch the knob for water - fall water

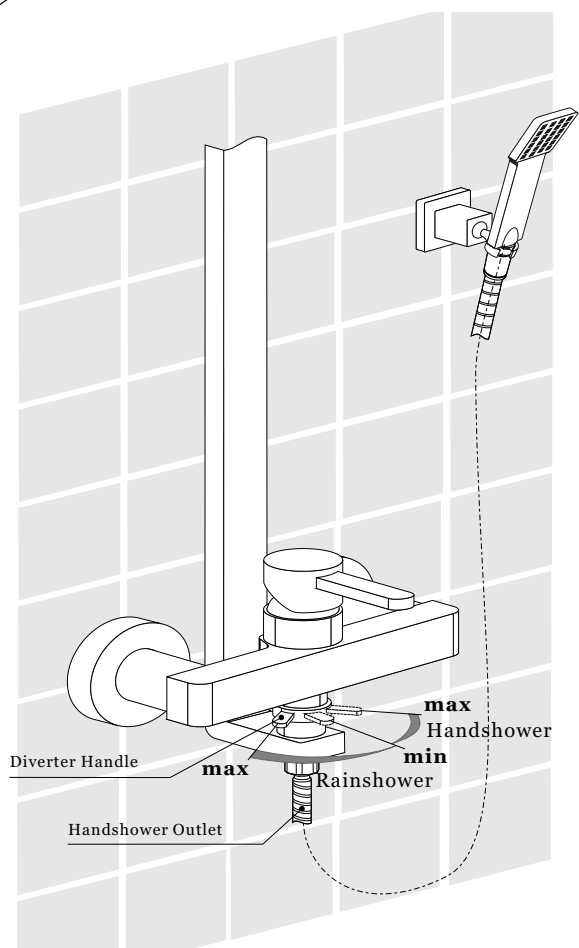

20

Switch the knob for water - fall water

